



Support & Downloads: EB-W31



[Return back to support options for Epson EB-W31](#)

[Print](#)

Wireless Projector Setup

This article will guide you through the wireless setup options of Epson projectors using the Epson ELPAP07 and ELPAP10 wireless adapter.

Installing the Wireless LAN Module

To use the projector over a wireless network, install the Epson 802.11b/g/n wireless LAN module in the projector. Do not install any other type of wireless module.

1. Remove the wireless LAN module cover screw.

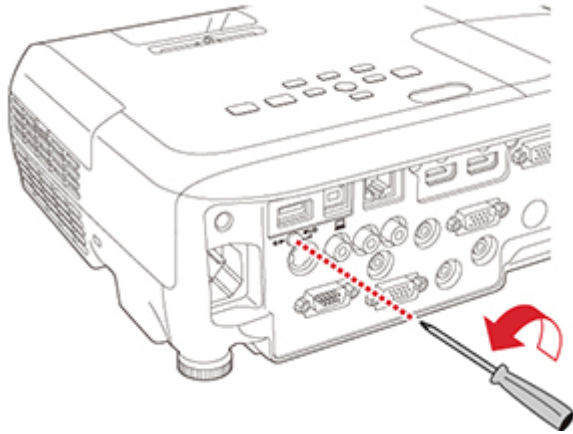

2. Install the wireless LAN module in the dedicated USB-A port.

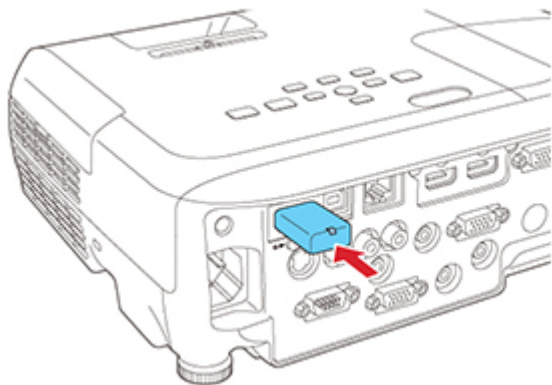

3. The light on the wireless LAN module turns on when the module is installed and operating. The light flashes when the module is communicating over the network.

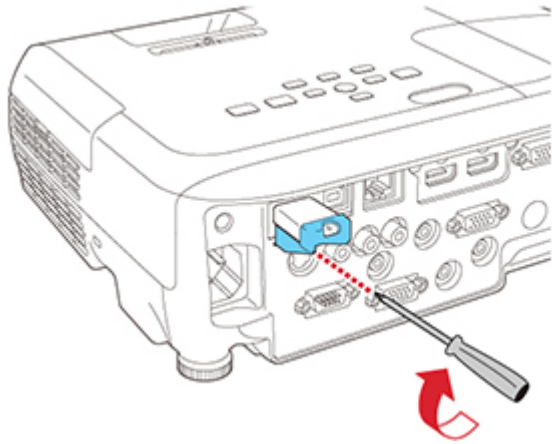

Using Quick Wireless Connection (Windows Only)

Selecting Wireless Network Settings Manually

Searching for a Wireless Network

Selecting Wireless Network Settings in Windows

Selecting Wireless Network Settings in OS X

Setting Up Wireless Network Security

Using a QR Code to Connect a Mobile Device

Supported Models

Did you find this article helpful

Yes No